

5. FORSTER STREET

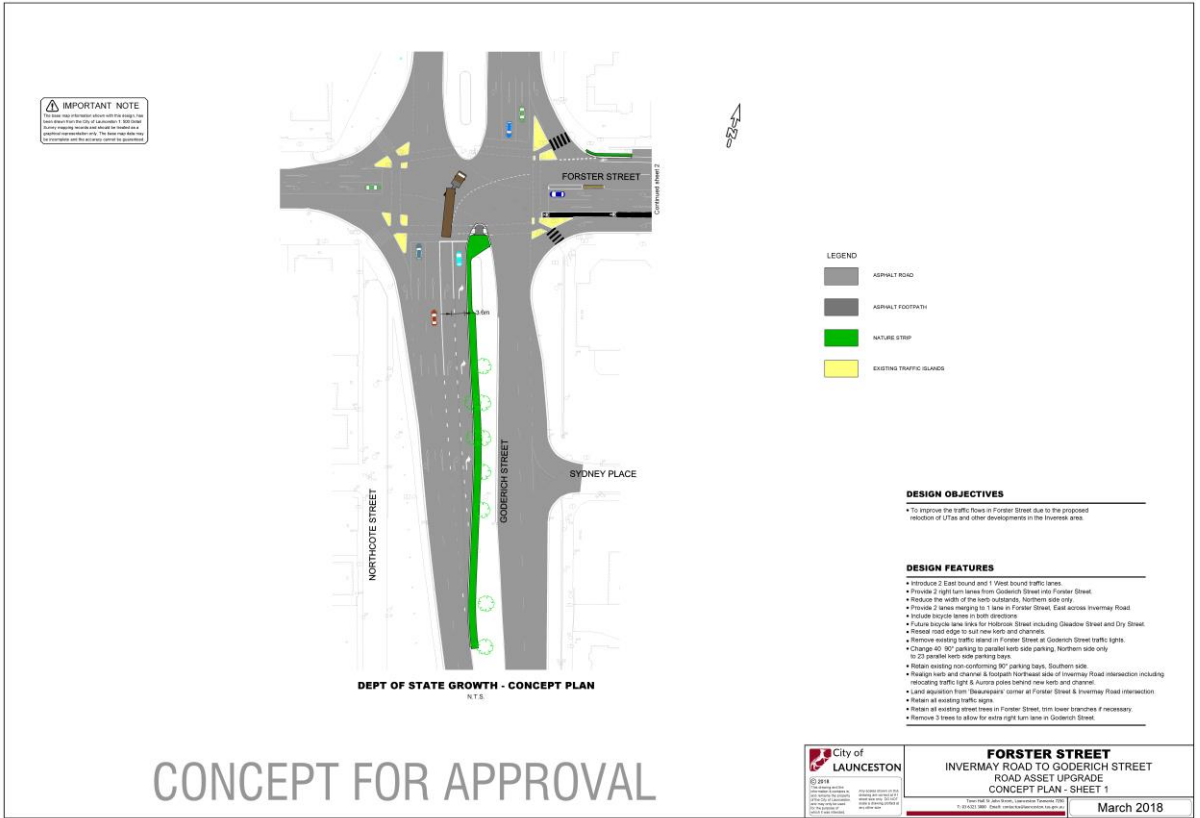

5. FORSTER STREET

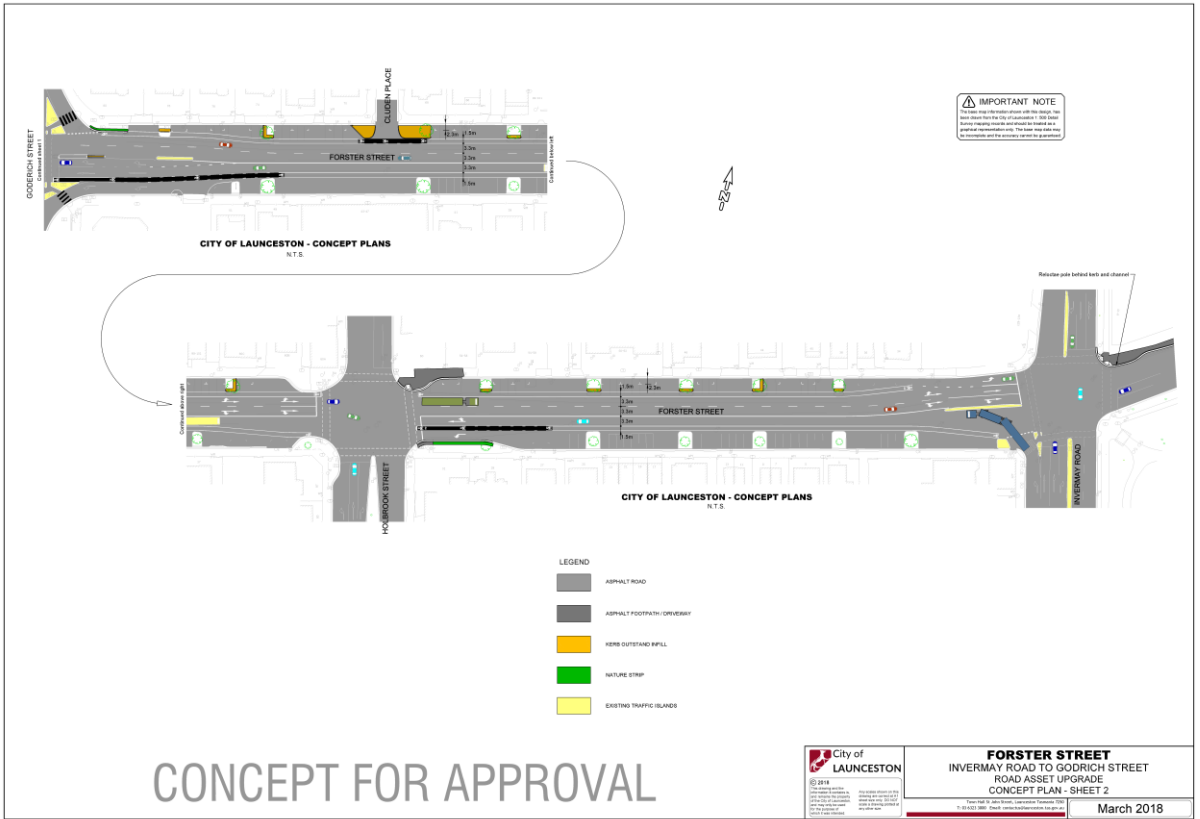

5. FORSTER STREET CROSS SECTIONS

IMPORTANT NOTE
 This plan and information sheet are for the design team only. It is not intended for public use. It is not to be used for any other purpose. It is not to be used for any other purpose. It is not to be used for any other purpose.

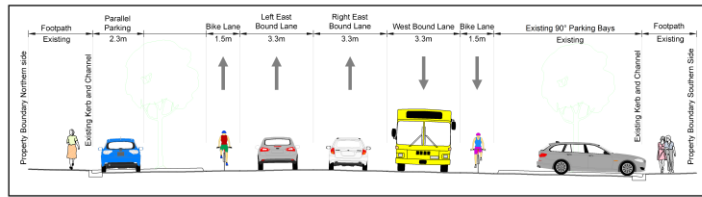

Forster Street Typical Section - Short Term
 N.T.S.

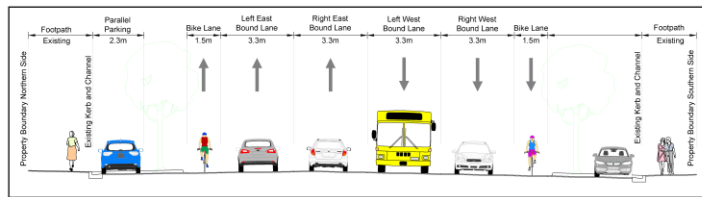

Forster Street Typical Section - Long Term
 N.T.S.

CONCEPT FOR APPROVAL

<p>City of LAUNCESTON 100 St Johns Street, Launceston, Tasmania 7250 Phone: (08) 3333 3333 Fax: (08) 3333 3334 Email: info@cityoflaunceston.tas.gov.au</p>	<p>FORSTER STREET INVERMAY ROAD TO GODERICH STREET ROAD ASSET UPGRADE TYPICAL CROSS SECTION - SHEET 3</p>
	<p>March 2018</p>

4. GODERICH STREET - GLEADOW STREET TRAFFIC LIGHTS

IMPORTANT NOTE
 This plan and information sheet are for the design team only. It is not intended for public use. It is not to be used for any other purpose. It is not to be used for any other purpose. It is not to be used for any other purpose.



CONCEPT PLAN
 1:500

SCALE - 1:500

- | DESIGN OBJECTIVES | DESIGN FEATURES |
|--|---|
| <ul style="list-style-type: none"> Upgrade Traffic Management. Provide new traffic lights at the intersection of Goderich Street and Gleadow Street. Reduce traffic congestion at Goderich Street and Loxley Street intersection. | <ul style="list-style-type: none"> Provide 2 right turn lanes from Gleadow Street in Goderich Street. Reconfigure road line marking and traffic islands to suit new intersection layout. Remove existing traffic islands and replace with road pavement. Install pedestrian crossings at new traffic lights. Maintain bicycle pathway on the Western side of Goderich Street. Realign footpaths to suit new kerbs and channels. Reinstall nature strips. Install new traffic signs. Realign all existing street trees. |

- LEGEND**
- ASPHALT ROAD
 - ASPHALT FOOTPATH / GRABWAY
 - TRAFFIC ISLAND INFILL
 - NATURE STRIP
 - NATURE STRIP

CONCEPT FOR APPROVAL

<p>City of LAUNCESTON 100 St Johns Street, Launceston, Tasmania 7250 Phone: (08) 3333 3333 Fax: (08) 3333 3334 Email: info@cityoflaunceston.tas.gov.au</p>	<p>GODERICH STREET GLEADOW STREET INTERSECTION TRAFFIC LIGHTS CONCEPT PLAN</p>
	<p>March 2018</p>

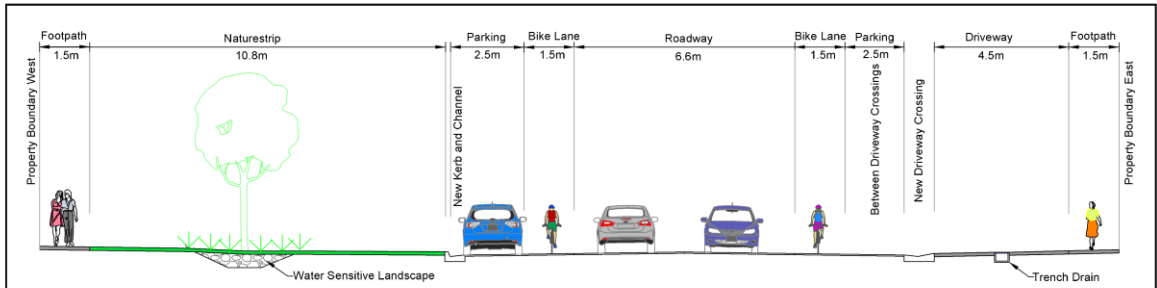

Montagu Street - Gladow Street to Forster Street
 Typical Cross Section
 N.T.S.

3. MONTAGU STREET

LEGEND

- ASPHALT ROAD
- ASPHALT FOOTPATH/SHOULDER
- CONCRETE DRIVEWAY
- NATURE STRIP

CONCEPT PLAN
1:500

Typical Cross Section
Montagu Street

DESIGN OBJECTIVES

- Reconstruct Montagu Street with new pavement, kerb and channel.
- Footpaths and nature strips with improved pedestrian and road safety.
- Construct new drainage network as required.
- Reduce traffic congestion at Goodrich Street and Lindsay Street intersection.

DESIGN FEATURES

- Reconstruct Montagu St from Forster Street to Gladow Street to accommodate parking bays and bike lanes.
- Construct new kerbs and channels and driveway crossings.
- Raise footpaths on the eastern side of the road and improve landscape areas to suit new kerb and channels.
- Improve pedestrian safety by installing access ramps.
- Improve road safety by providing on-street parking bays, bike lane and line markings as shown on the plan.
- Upgrade and install new stormwater drainage system.
- Respect the road, footpaths and driveways with asphalt and concrete to match existing.
- Provide industrial driveway crossings at the entries to businesses as per requirement.
- Introduce Urban Sensitive landscapes to increase the quality of the stormwater entering the drainage system.
- Plant new trees to improve aesthetics of the road.

IMPORTANT NOTE
This plan is for public consultation only. It is not a final design and should not be used for construction purposes. The design is subject to change without notice.

City of LAUNCESTON

**MONTAGU STREET
GLEADOW STREET TO FORSTER STREET
ROAD ASSET UPGRADE
CONCEPT PLAN**

MAY 2018

CONCEPT FOR PUBLIC CONSULTATION

IMPORTANT NOTE
 Please refer to the project website for more information. The City of Launceston reserves the right to amend the design and the location of the proposed works at any time without notice. The design and the location of the proposed works are subject to the final design and the location of the proposed works.



CONCEPT PLAN
 1:500

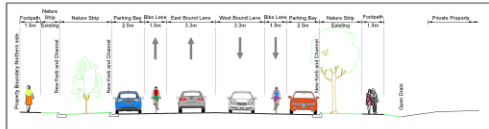

Gleadow Street - Goderich Street to Link Road
 Typical Section
 N.T.S.

- LEGEND**
- ASPHALT ROAD
 - ASPHALT FOOTPATH/DRIVEWAY
 - CONCRETE DRIVEWAY
 - NATURE STRIP

DESIGN OBJECTIVES

- Upgrade Gleadow Street from Goderich Street to the proposed Link Road.

DESIGN FEATURES

- Convert tree beds and channels, both sides.
- Match with proposed road asset upgrade in Montagu Street.
- Asphalt overlay the existing concrete road surface between the new kerb and channels.
- Provide line markings for traffic lanes, bike lanes and vehicle parking.
- All parking bays are parallel to the kerb.
- Bicycle lane links to the existing Goderich Street bicycle lane.
- Construct new footpaths: Southern side of Gleadow Street and West of Montagu Street, Northern side.
- Reveal the existing Northern side footpath including a safer pedestrian crossing at Montagu Street.
- Construct driveway crossings at Hornbrook Street junction and at all existing driveways.
- Remove all existing piped driveway culverts and replace with graded concrete trench drains.
- Upgrade all street lighting to street light poles.
- Upgrade landscape areas to suit new kerbs and channels.
- Introduce Urban Sentinel landscape elements to the road distributor runoff.
- Retain existing street trees in Gleadow Street, trim lower branches if necessary.
- Remove 1 tree near driveway to 75-84 Gleadow Street to allow for new kerb and channel.

0 100 200 300 400 500 METRES
 SCALE - 1 : 500

CONCEPT FOR PUBLIC CONSULTATION



GLEADOW STREET
 GODERICH STREET TO NEW LINK ROAD
 ROAD ASSET UPGRADE
 CONCEPT PLAN

May 2018