

TASMANIAN PLANNING SCHEME - LAUNCESTON

Amendment PSA-LLP0030

Rezoning part of 43 Los Angeles Road, Swan Bay (also described as 729-739 John Lees Drive, Dilston), from Agriculture to Rural, as described below: Title included: 165889/1

Amend the Tasmanian Local Provisions Schedule maps as below:

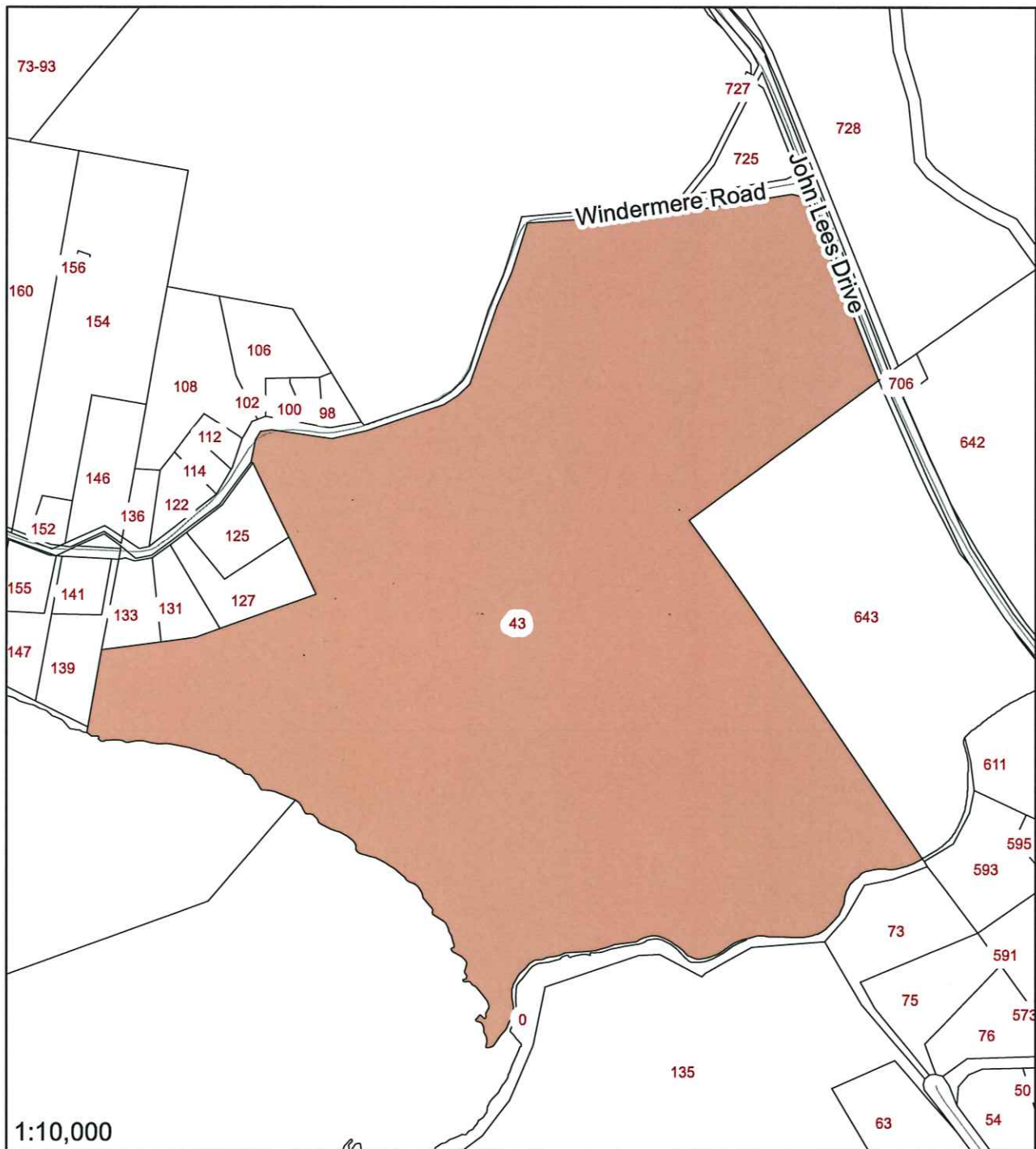

Zoning



Rural Zone

THE COMMON SEAL
of the City of
Launceston was
hereunto affixed in the
presences of: -

Date 20/06/2025



Sam Johnson OAM
Chief Executive Officer

TASMANIAN PLANNING SCHEME - LAUNCESTON

Amendment PSA-LLP0030

Insertion of the Priority Vegetation overlay at 43 Los Angeles Road, Swan Bay (also described as 729-739 John Lees Drive, Dilston) as described below:

Title included: 165889/1

Amend the Tasmanian Local Provisions Schedule maps as below:

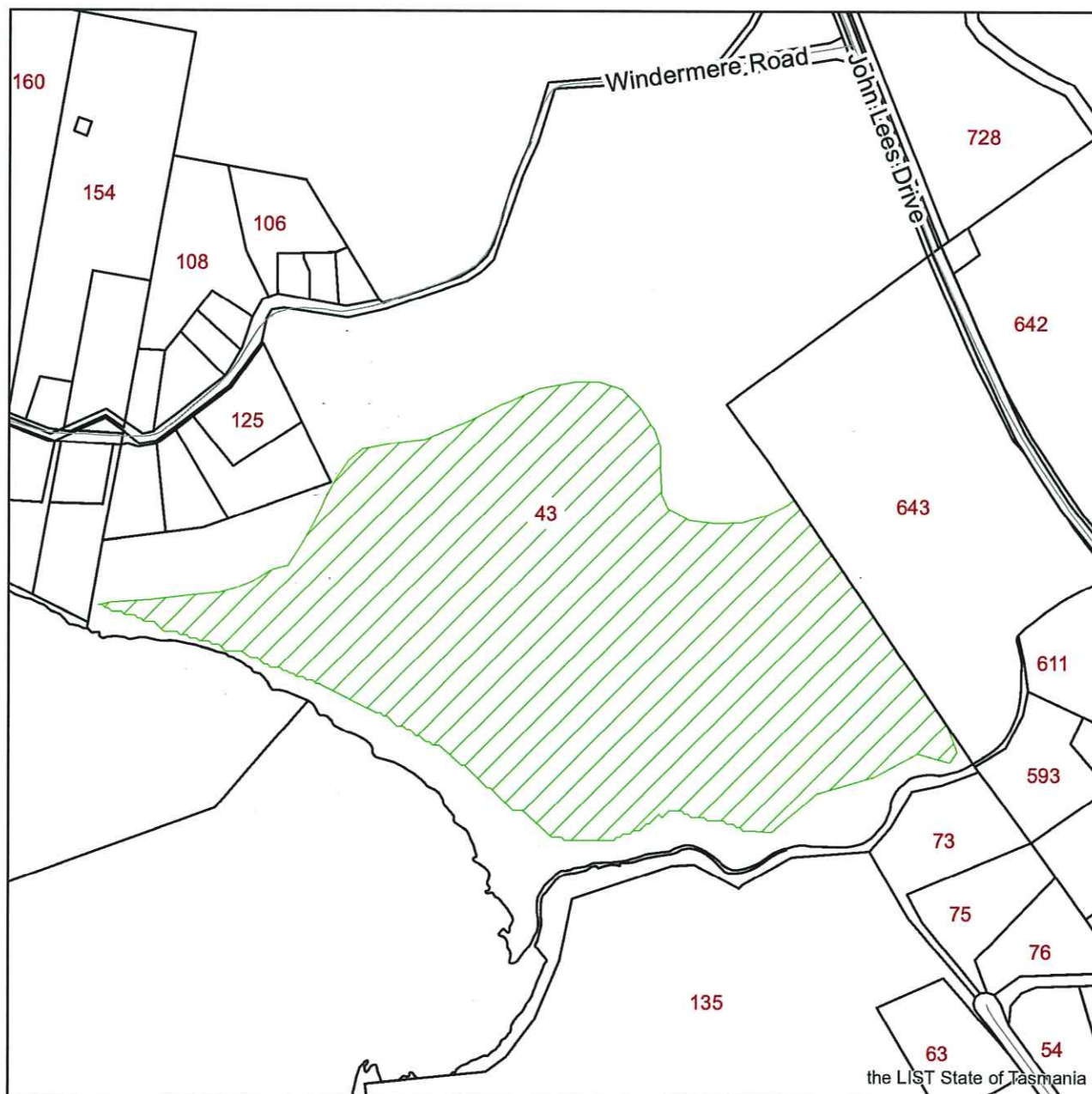

Code Overlay



Priority Vegetation Area

THE COMMON SEAL
of the City of
Launceston was
hereunto affixed in the
presences of: -

Date 20/06/2025



A blue ink signature of Sam Johnson OAM.

Sam Johnson OAM
Chief Executive Officer